

# SIGNATURE

## NORTH EAST

OFFICIALLY RATED THE NO.1 ESTATE AGENT IN THE NORTH EAST







Hartford Hall Estate, Bedlington NE22 6AG



# Hartford Hall Estate Bedlington NE22 6AG

Offers In The Region Of  
£595,000

Signature North East is excited to present a truly rare and enviable opportunity to acquire the stunning luxurious two-bedroom ground floor apartment, which is available with no upper chain and is situated within one of Northumberland's most sought-after estates. Set within a Grade II listed building, the property boasts a wealth of charm and character which incorporates both original and modern features.

A truly remarkable domed Orangery is an enviable focal point of the accommodation. This room offers multiple triple aspect double glazed windows with open ventilation systems, providing an abundance of natural light and breathtaking views of the gardens. This space is perfect for enjoying all year round and a peaceful retreat at night.

Leading on from the Orangery into an elegant south-facing open plan lounge/kitchen with ornate ceiling details, original paneling, an outstanding and ornate original marble fireplace surrounding a gas-burning log effect fire. There are 3 large cast iron radiators and solid wood flooring with French doors leading out to south facing garden.

The spacious kitchen area features bespoke units, granite work surfaces, and a large island unit with integrated appliances ideal for entertaining.

The property boasts two generously sized bedrooms, both featuring an en suite bathroom with modern fixtures and fittings, including showers and toilets.

The extensive garden is a haven of peace and tranquility, offering a wide range of outdoor spaces, perfect for relaxing and entertaining. The gravel area to the rear of the property is a captivating spot, offering an exclusive and magical view of the surrounding nature. The gardens also provide direct access to the communal grounds, allowing residents to enjoy even more outdoor space and beautiful scenery.

Experience luxury living in this unique and opulent two-bedroom garden apartment, situated in the historic Hartford Hall, which dates back to 1807. The apartment has been sympathetically renovated to a very high standard, while retaining its original period features. The maintained private gardens and grounds are simply beautiful.

Both double bedrooms have en suite bathrooms, and each has fitted storage. The master bedroom suite includes a dressing room with fitted wardrobes and drawers, oak flooring. The apartment also includes a single garage in an adjacent block.

The Palm House is set within beautiful private gardens extending into the surrounding 55 acres of private estate woodland gardens of this prestigious Georgian country estate. With its abundant wildlife and riverside walks its an oasis for nature lovers who desire tranquility.

Located in the prestigious private Hartford Hall Estate, for those who enjoy exploring further afield, the property is within easy reach of main road links to Morpeth, Bedlington, Cramlington and A1 to Newcastle city centre and also offers easy access to the stunning North East coastline and beyond Signature North East invites you to view this rare opportunity to purchase such a desirable exquisite home.









### Why Signature?

Signature North East reach 150,000 per month on social media. We cover 19 locations in the North East. At signature we keep our doors open from 8AM - 8PM, when other estate agents are closed. We are a customer 5 star rated agent on allagents.co.uk. With a dedicated group of negotiators across the region, to the 'behind the scenes' Head Office team, each member of staff is passionate about the industry and cares about every client; you're at the heart of everything we do!

PLEASE NOTE THAT THE VENDOR HAS CERTIFIED THE PROPERTY INFORMATION AND IMAGES.

# PROPERTY FLOORPLAN

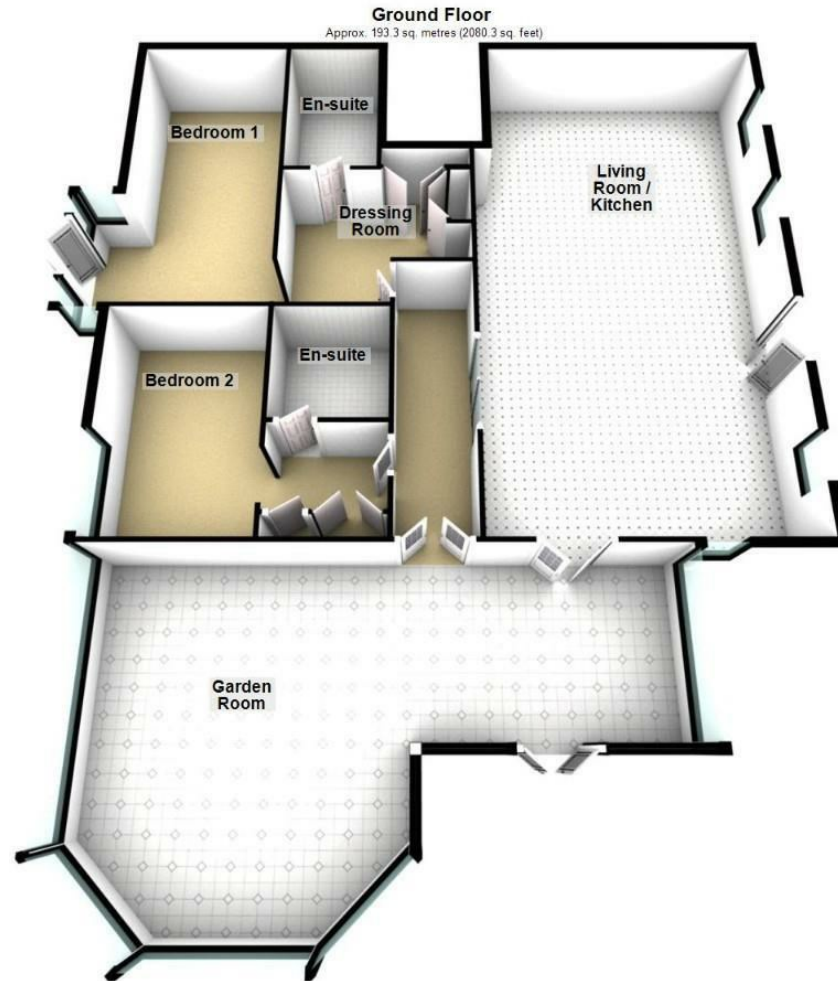

Total area: approx. 193.3 sq. metres (2080.3 sq. feet)

Please be advised the floorplans are not drawn to scale and are to be used to give an idea of the layout of the property.  
Plan produced using PlanUp.

EPC RATING: D





More 5 Star Customer Reviews than any other Agent based in the North East on allAgents.co.uk



**SALES**

**LETTINGS**

**FINANCE**

**LAW**

**WE COVER THE WHOLE OF THE NORTH EAST**

Whitley Bay  
0191 251 3344

Cramlington  
01670 897 213

Tynemouth  
0191 296 6689

Morpeth  
01670 513 966

Ponteland  
01661 820 082

Wallsend  
0191 432 4151

Alnwick  
01665 511 800

Heaton  
0191 432 4275

Forest Hall  
0191 266 9966

Other locations  
0191 640 3523

Newcastle  
0191 640 2284

Durham  
0191 303 8252

Gosforth  
0191 640 3523

Sunderland  
0191 543 6390

Whickham  
0191 432 5102

Gateshead  
0191 432 4294

Jesmond  
0191 281 1037

Killingworth  
0191 640 3602

Ryton  
0191 413 9845

Head Office &  
Lettings  
0191 253 4815

\*Highest recommended 5-star reviews than any other Estate Agent based in the North East on allAgents.co.uk - The UK's Largest Customer Review Website for the Property Industry & Awarded Best Estate Agency 2018 & 2019 - North East England by SME News